



Rear Engine Exhaust Cables

BULLETIN

Models Affected: Certain 2011 – 2017 Model Year Rear Engine All American Buses with a Selective Catalytic Reduction (SCR) and Diesel Particulate Filter (DPF).

ISSUE

Rear engine exhaust support cables may fail.

CORRECTIVE ACTION

Replace existing 5.5 inch cable assembly with new 6.0 inch cable assembly 10047279.

PROCEDURE

WARNING:

Always follow all Federal, State, Local, and Shop safety standards and use proper safety equipment, and thoroughly read and understand all instructions before performing these procedures.

CAUTION:

Allow exhaust system to cool prior to performing these procedures to prevent the risk of severe burns.

1. Park the bus on a level surface, apply parking brake, turn off engine, remove ignition key, and chock wheels.
2. Locate the four muffler hanger strap assemblies supporting the SCR and DPF at the rear of the bus.
3. Support the SCR and DPF, and replace the eight (8) 5.5 inch exhaust support cable assemblies with eight (8) 6.0 inch exhaust support cable assembly 10047279. Replace each cable assembly by removing the nut at the top of the cable assembly and the nut and washer at the bottom of the cable assembly. Discard old nuts, DO NOT reuse. Remove and discard the 5.5 inch cable assembly. Install the new 6.0 inch cable assembly and new nut at the top and new nut and washer at bottom.
4. Torque upper 3/8" nut to 72 – 78 in-lb. Torque lower 3/8" nut to 29 - 33 ft-lb.

See Sheet 2 for illustration



Rear Engine Exhaust Cables

BULLETIN

SERVICE BULLETIN - S I 6 Y J

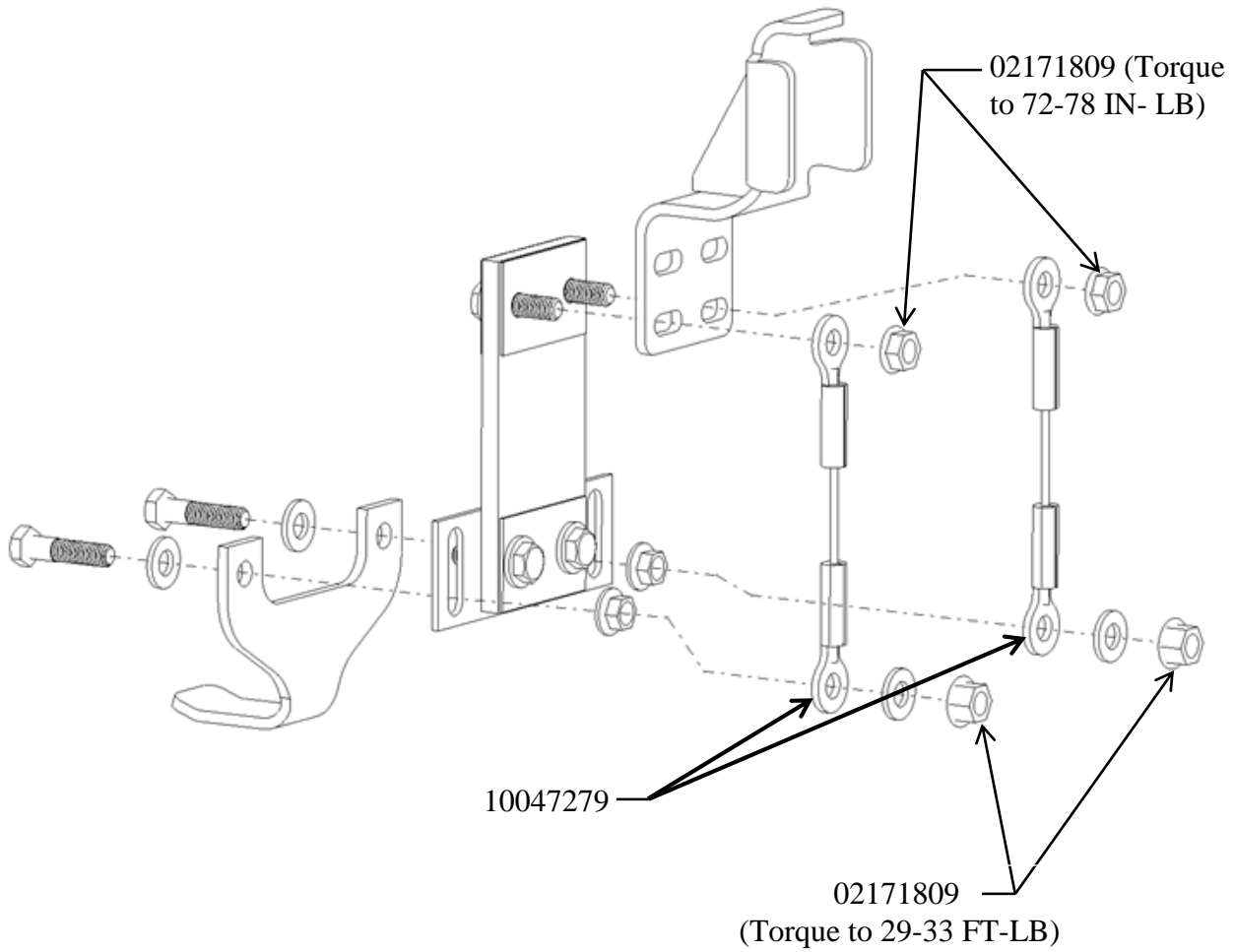

Parts List		
Part #	Description	Qty
10047279	CABLE ASSY, SUPPORT,6.00",EXHAUST, T3RE	8
02171809	NUT,HEX HD,3/8-16,SM FLG LK	16